

SPLICE KIT



PART NUMBER	DESCRIPTION	WT. per box	QUANTITY per box
SPLICE KIT	3 piece staked bolt/washer and nut combination used to splice straight sections and fittings.	5 lbs	50 sets

STANDARD FINISH: ZINC PLATED | AVAILABLE IN FINISH: **BL**

WASHER SUPPORT

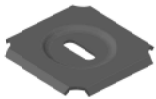

PART NUMBER	DESCRIPTION	WT. per box	QUANTITY per box
WASHER SUPPORT	2" square washer that can be used to splice straight sections and fittings. This part can also be used as a hold down method.	6 lbs	50 each

STANDARD FINISH: ZINC PLATED | AVAILABLE IN FINISHES: **BL, PW, CPC**

BAR SPLICE



PART NUMBER	DESCRIPTION	WT. per box	QUANTITY per box
BAR SPLICE	Slotted bar 11-15/16" long used to splice straight sections and fittings.	14 lbs	50 each

STANDARD FINISH: ZINC PLATED | AVAILABLE IN FINISHES: **BL, PW, CPC**

CORNER SPLICE

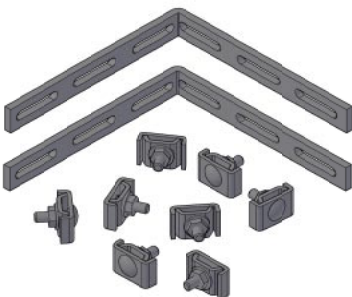

PART NUMBER	DESCRIPTION	WT. per box	QUANTITY per box
CORNER SPLICE	Kit used to splice fittings. Each kit includes two 90 degree splice bars and 8 sets of the splice kit.	1 lbs	1 kit

STANDARD FINISH: ZINC PLATED | AVAILABLE IN FINISH: **BL**